

Zubehör

Messplatte **KM-1016-0**
gehärtet-geschliffen

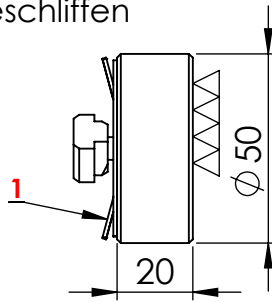

1 = Schutzscheibe
Mat.Niro S=1mm

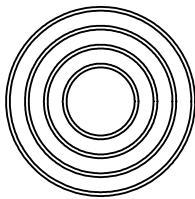
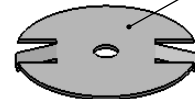

Messplatte **KM-1017-0**
gehärtet-geschliffen

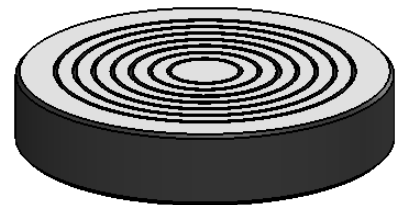
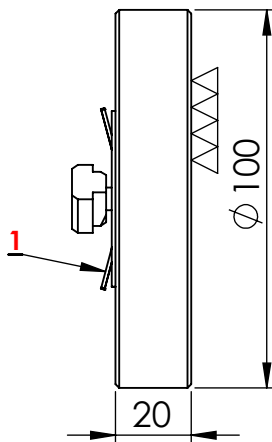
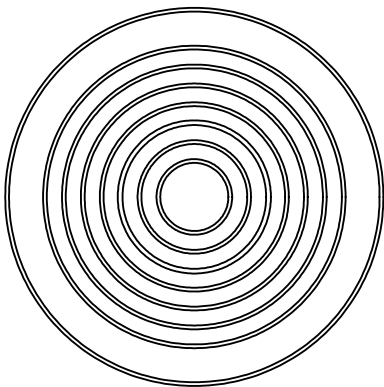

Verlängerung KM-1010-0 (-1) für Universalschwenkarm **MD-3010**
Bestellnummer - **0** = Aluminium blau-eloxiert
- **1** = Stahl matt-vernickelt

